

Parts Included:

- Boom Plate (1)
- Frame Plate (1)
- Quick Release Skewer (2)
- Sleeve Washer (2)
- 10 Tooth Idler Wheel (2)
- 10mm Idler Spacer (1)
- 20mm Idler Spacer (1)
- M8x30mm Bolt (1)
- M8x40mm Bolt (1)
- M8 Nyloc Nut (2)
- 8spd Chain & Quick Link Set (1)
- 9spd Chain & Quick Link Set (1)
- 10spd Chain & Quick Link Set (1)
- 11spd Chain & Quick Link Set (1)
- Cable Management Strap (1)

Tools Needed:

- 3mm Hex Wrench
- 5mm Hex Wrench
- 13mm Socket Wrench
- Chain Tool

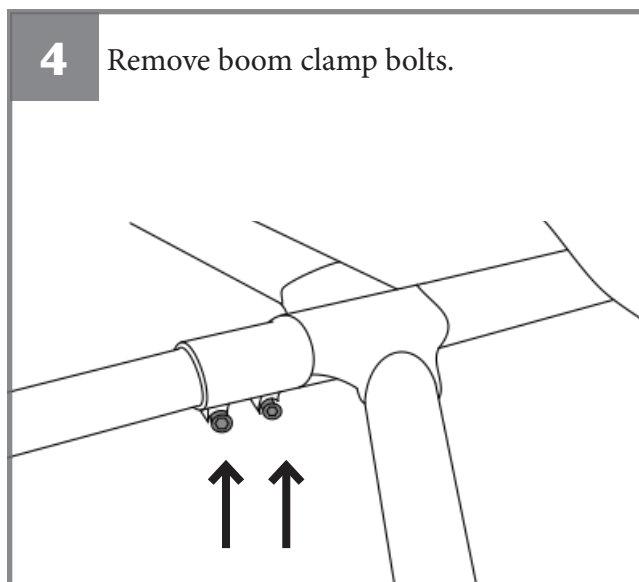
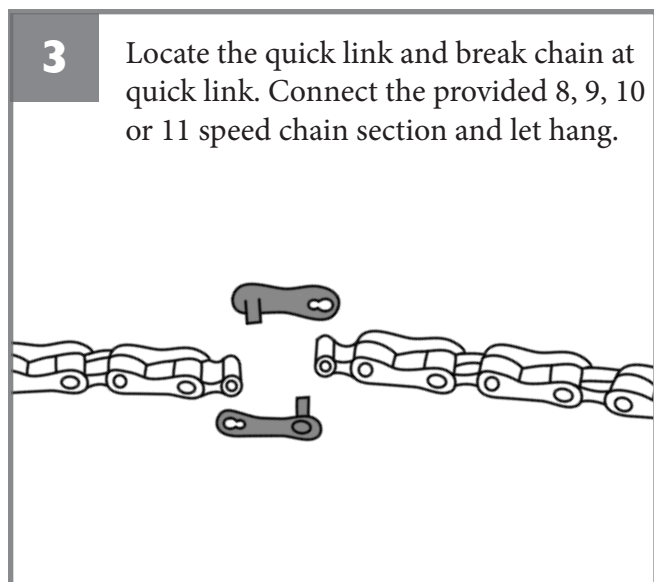
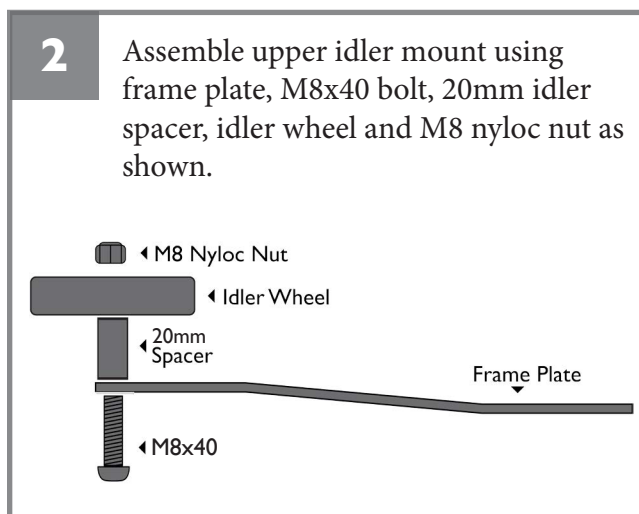
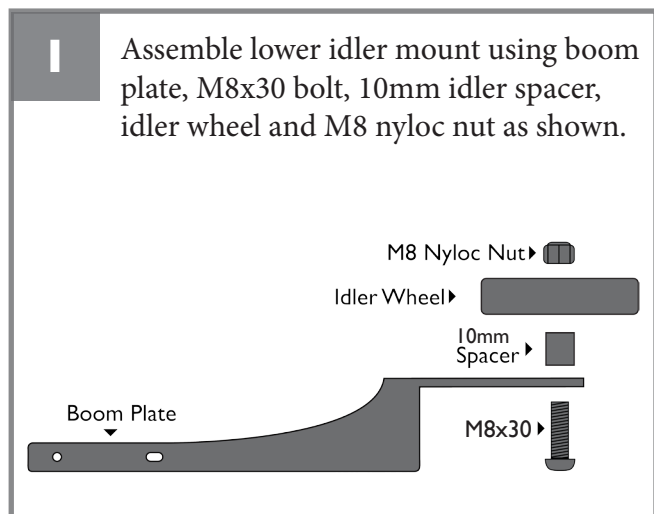

5

Clip zip ties and with 3mm hex wrench remove the cable management guides.

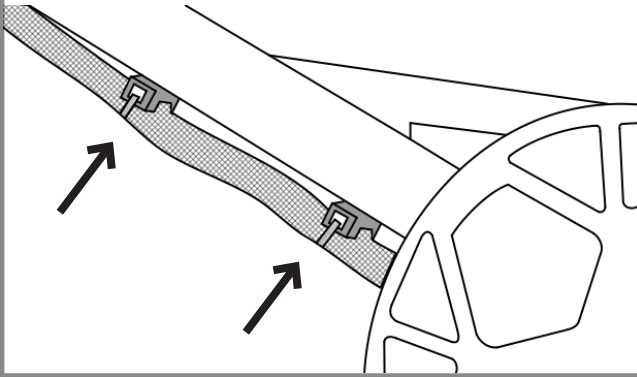

6

Install boom plate, reinsert cable management guides, ziptie cables down and trim excess zip ties.

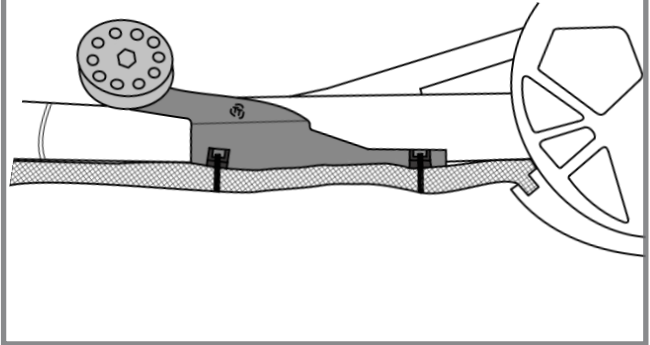

7

Insert quick release sleeve washers. Remove quick release caps and insert quick releases.

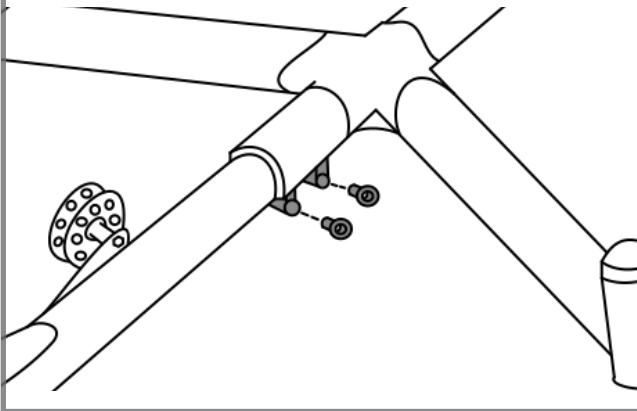

8

Place frame plate on end of quick releases and secure with caps.

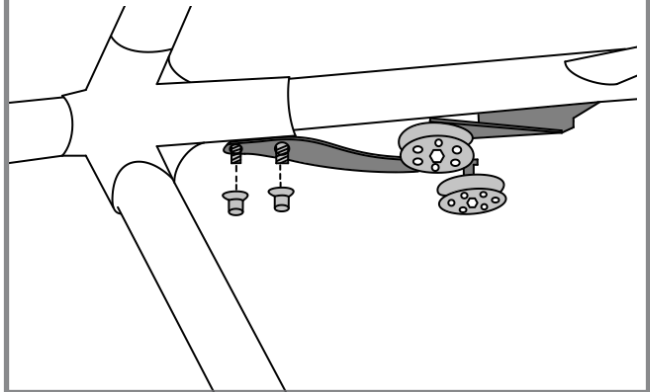

9

Route chain through the idlers as shown.

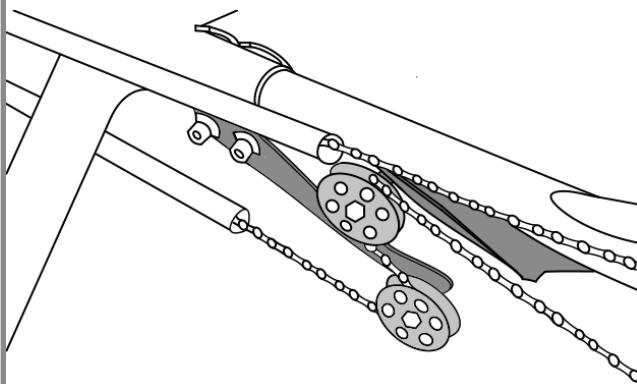

10

Tighten and close quick release levers one at a time. Re-tighten the first lever and close again. Use cable management strap to secure loose cables to frame.

