

Tools:

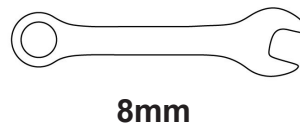

Parts:

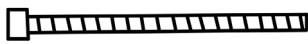

M5x70 X 2



M5x16
w/washer X 4



M5x16 X 4

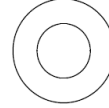

M5 flat washer X 2



M5 nyloc
nut X 4



M5 nut X 6

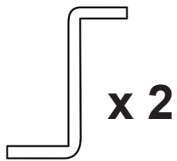

Clamp Bracket X 2



Lower Chainstay
Clamp X 2

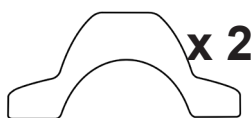

Upper Chainstay
Clamp X 2



Lower Main
Clamp X 1

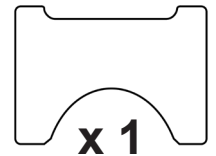

Upper Main
Clamp X 1

1. Attach Upper and Lower Main Clamps to the main frame. Do not tighten bolts until completely assembled.

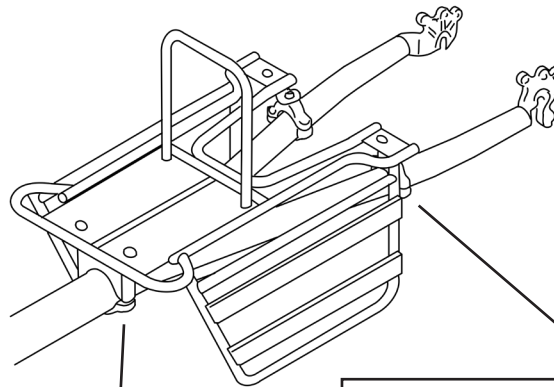

2. Mount Chainstay Clamps as shown. Do not tighten bolts until completely assembled.

