

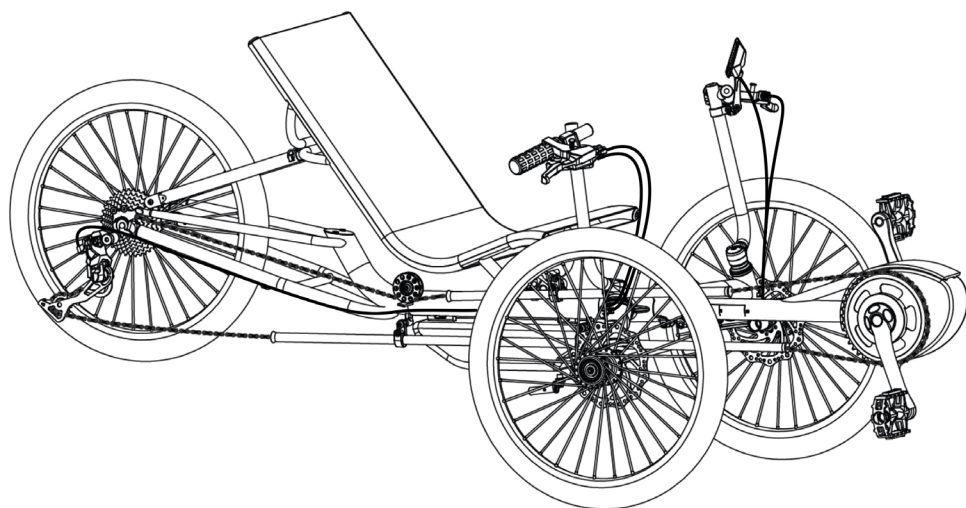

# ***TerraTrike***®



# **EVO**

**ELECTRIC VEHICLE OPTION**

## **Build Notes**



**Caution:** Boom and main frame are connected by the battery wire. Move both pieces together so the battery wire does not get damaged.

**Look through entire setup guide before beginning.**

**Small parts box:**

**Speed Sensor Magnet**

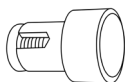

**x 1**

**Lock Keys**

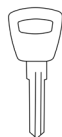

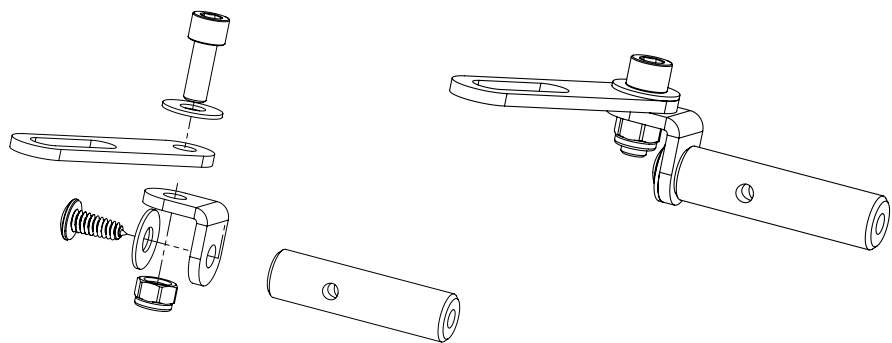

**x 2**

# Speed Sensor Bracket

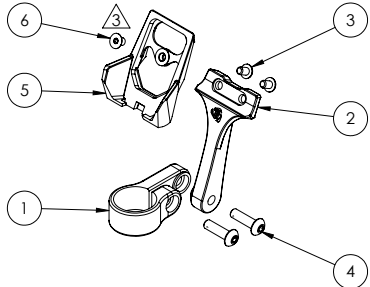
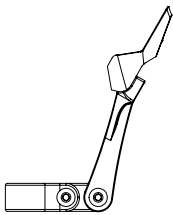

# Kiox Display

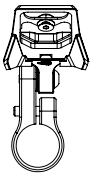

ITEM NO.	PART NUMBER	DESCRIPTION	QTY.
1	TT000854	CLAMP, ACCESSORY MOUNT 7/8"	1
2	TT000851	EVO DISPLAY MOUNT RISER	1
3	WH000006	M4x.7 X 6mm SBHCS SS	2
4	WH000002	M5x.8 X 18mm SBHCS SS	2
5	TT000906	BOSCH, KIOX DISPLAY BRACKET	1
6	WH000059	M4x0.7x6mm Flat Head SS	1

**1**

Using caution to not stress wires,  
insert boom to desired length and snug boom  
pinch bolts to secure boom.  
Speed Sensor, Kiox Display and Controller will be  
hanging loose.

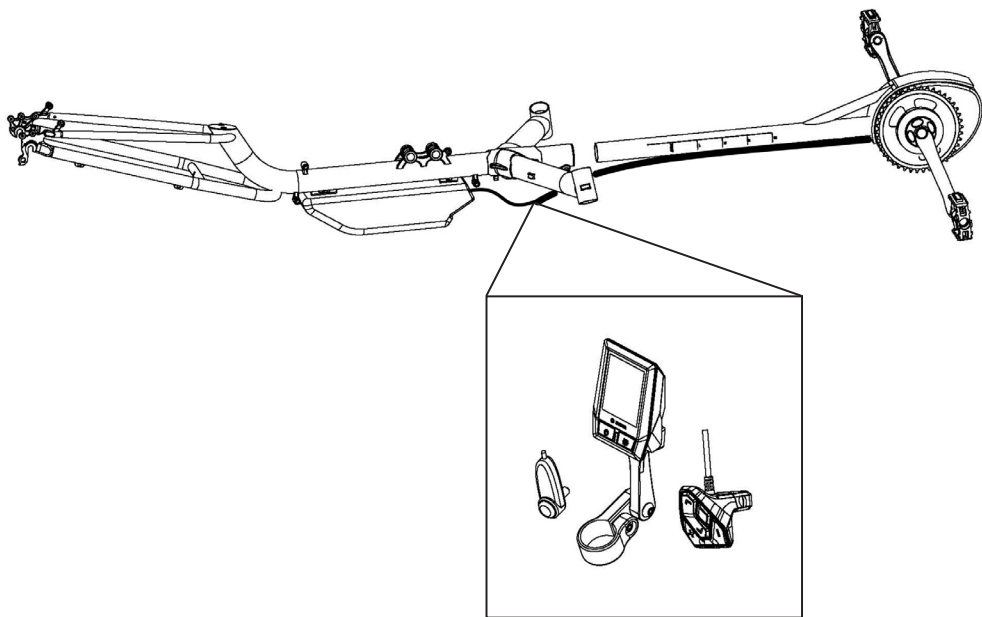

2

Apply cable guide to bottom side of right outrigger.

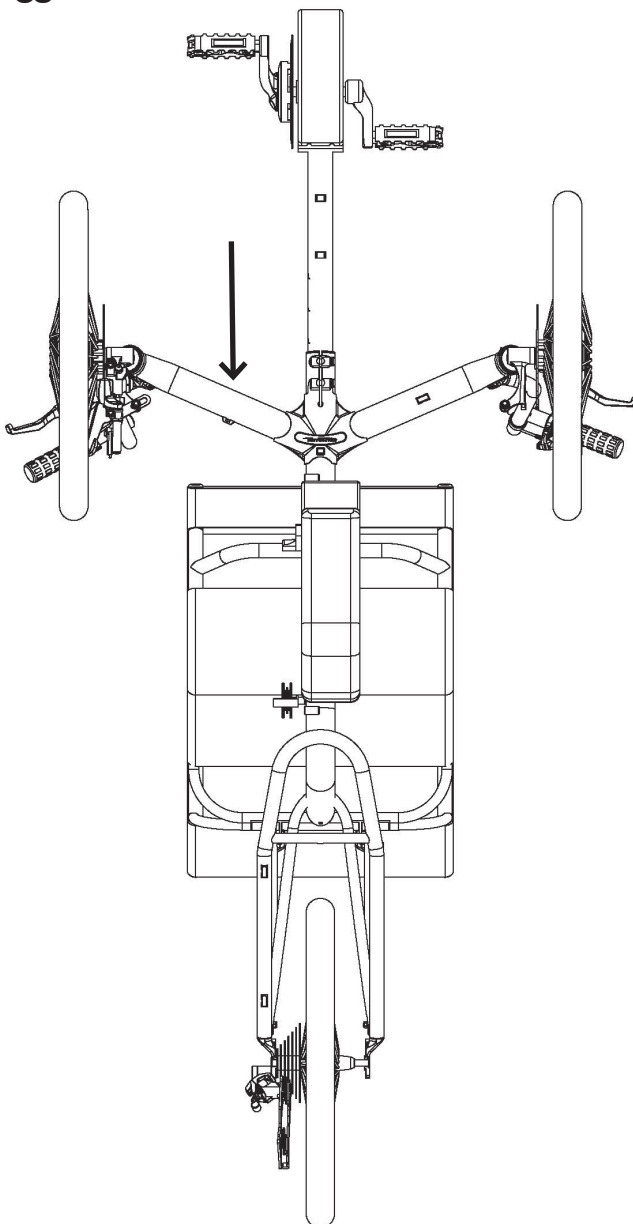

**3**

Install computer sensor bracket.

Mount speed sensor on computer sensor bracket.

Refer to Step 6 for proper wire routing.

Install magnet on spoke.

Align magnet and marking on speed sensor.



Ensure speed sensor wire is clear of brake rotor and any steering parts that could cause damage.

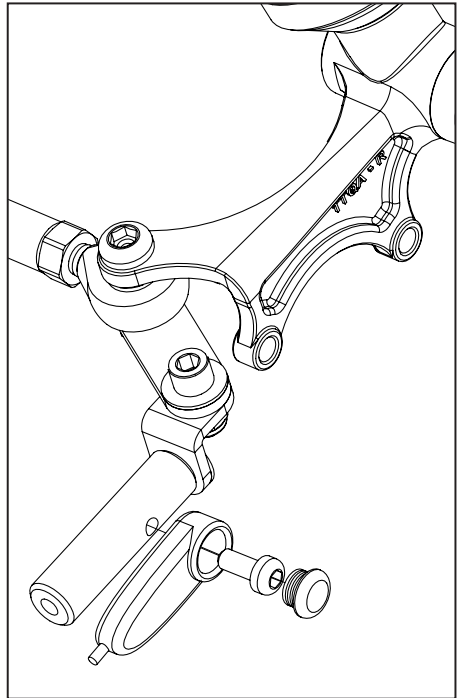
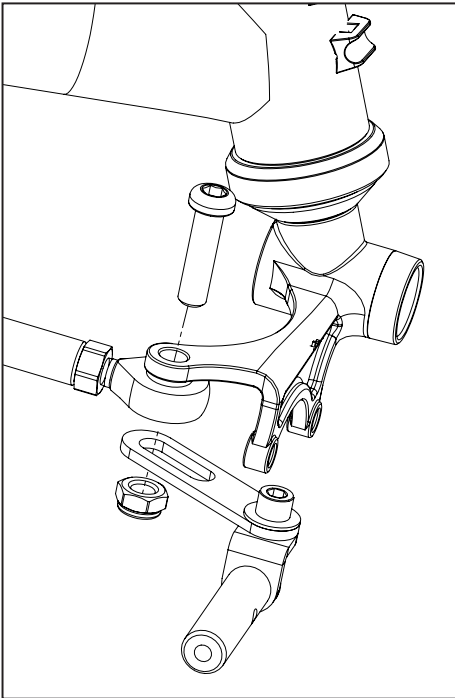

4

Attach computer mount to left handlebar.  
Refer to Step 5 for proper wire routing.  
Mount Kiox Display and secure.

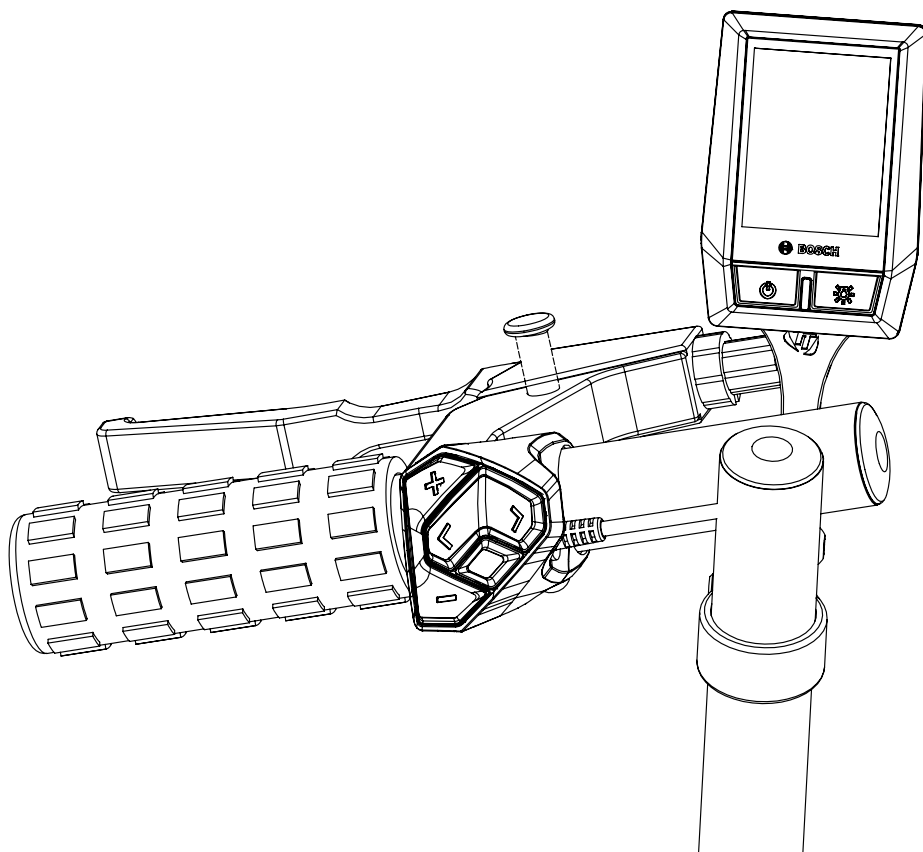

**5**

Route wires according to diagram (underside of trike frame).

Kiox cable should follow brake cable routing. Use the cable housing guide under the center lug of the frame to secure excess wires with ziptie.

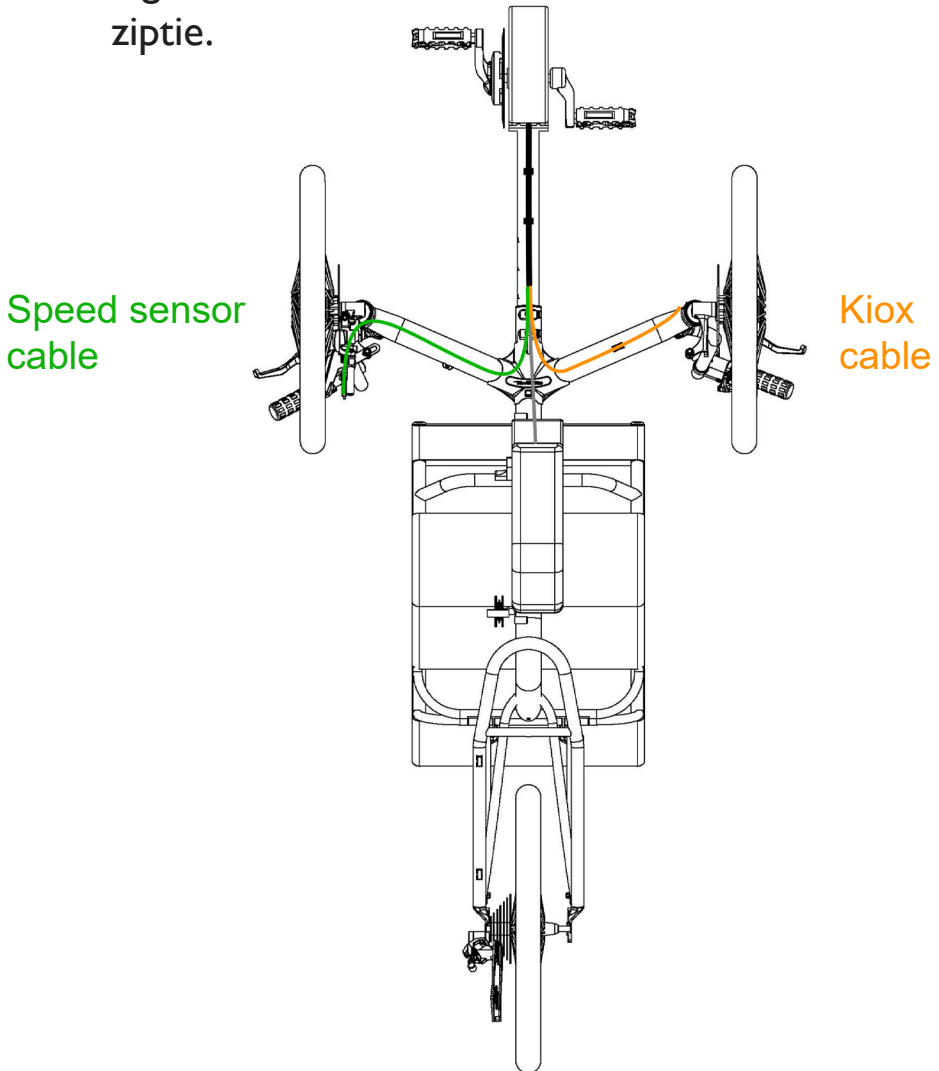



## Alignment

Inflate tires before performing alignment. The E.V.O. alignment measurement is approximately  $29\frac{5}{8}$  inches (center tread to center tread), though slight variance is possible. Most importantly, make sure the alignment remains neutral with a rider seated in the trike.

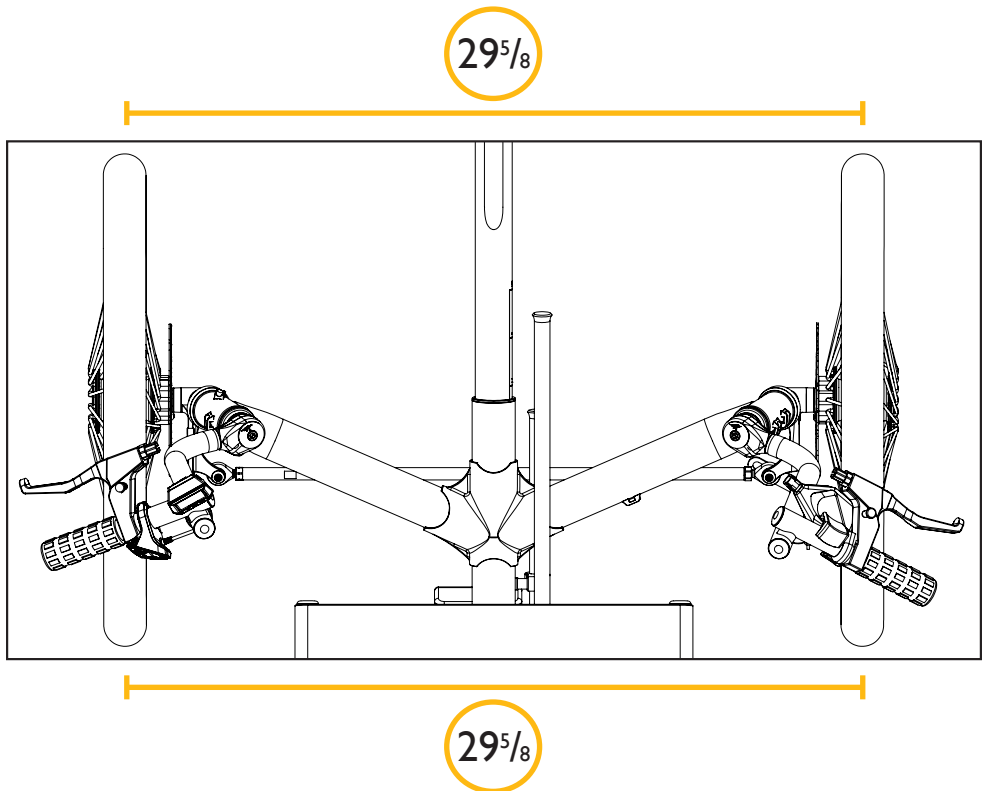

## Hybrid Steering Stack Assembly\*

Assemble the steering stack as shown. Grease the steerer tube before inserting into head tube. Remove any excess grease from steerer tube before installing handlebar. Grease axle before installing wheel. Torque axle to 23-25Nm.

\*Right Hand assembly depicted. Some components can be purchased individually as well as in pairs, see parts list below.

### Parts List

1	M6x30 Bolt	TT000576
2	Hybrid Top Cap	TT000506
3	Trigger Handlebar - RH	TT000649
	Trigger Handlebar - LH	TT000650
	Trigger Handlebar - Pair	TT000514
	M5x20 Bolt - 2qty (not pictured)	TT000301
4	Hybrid Headset Spacer	TT000520
5	Hybrid Headset Cap	TT000505
6	Bushing (pre-installed)	TT000809
7	Hybrid Headset Cup (pre-installed)	TT000602
8	Hybrid Headset Bearing	TT000600
9	Rapid Axle Hubmount - RH	TT000713
	Rapid Axle Hubmount - LH	TT000714
	Rapid Axle Hubmount - Pair	TT000516
10	Rapid Axle - RH	TT000717
	Rapid Axle - LH	TT000718
	Rapid Axle - Pair	TT000563
11	Axle Spacer	TT000568

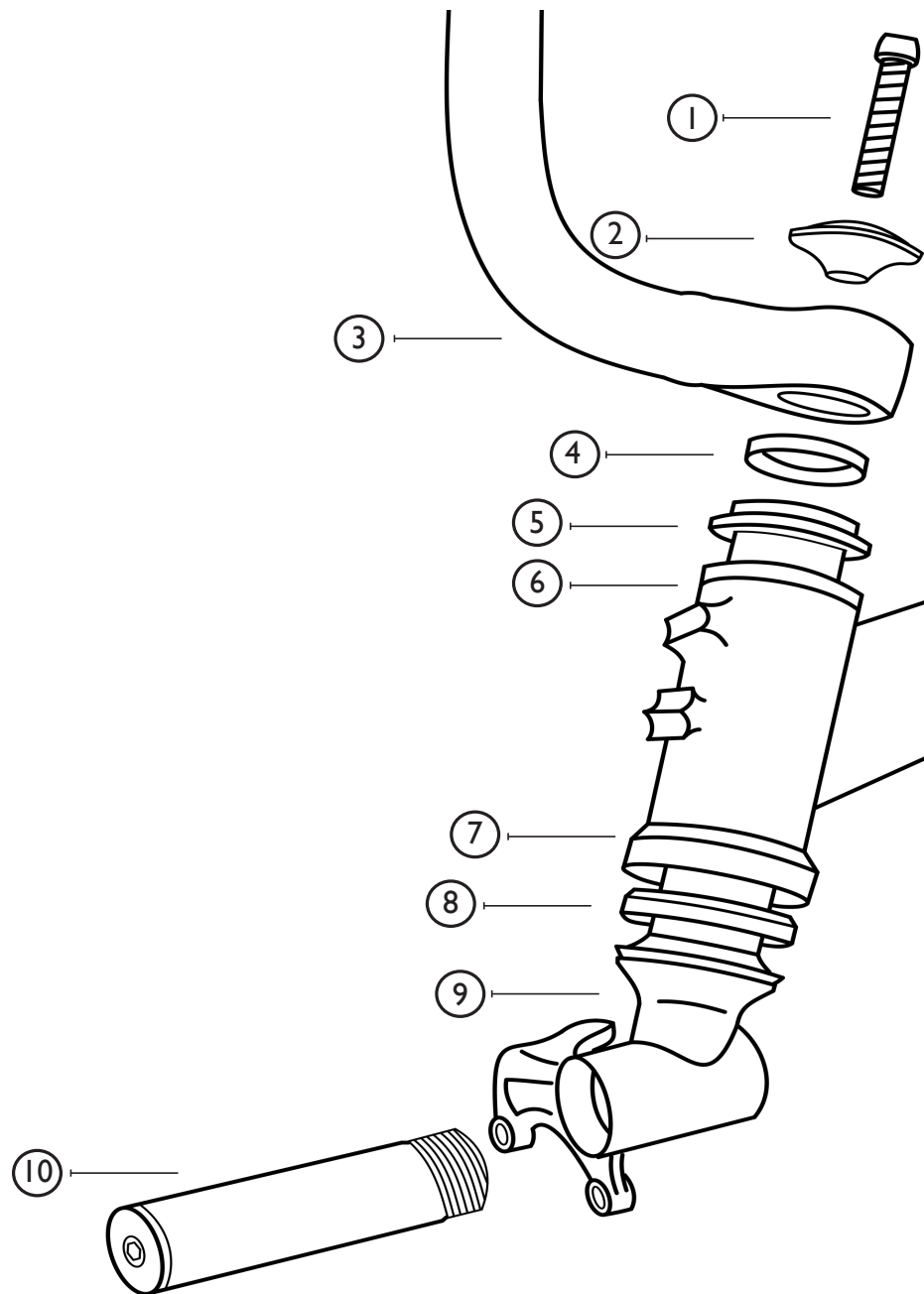

## Hybrid Steering Stack Assembly Continued\*

Install Axle Spacer (11) between brake rotor and hub.

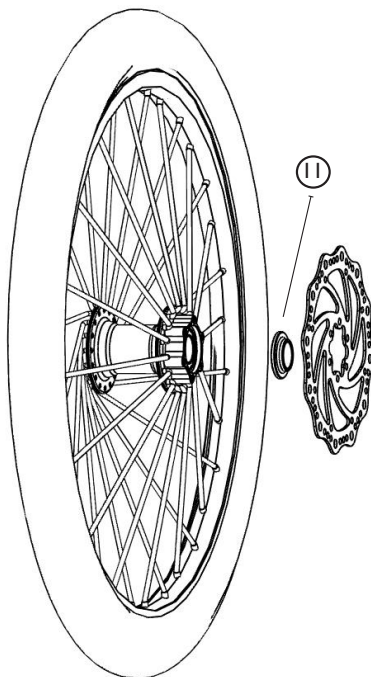

## Lower Chain Tube Setup

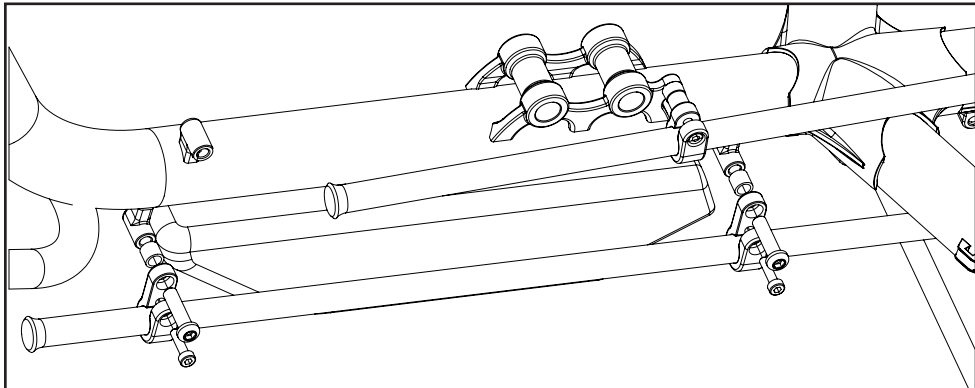

## Idler Setup

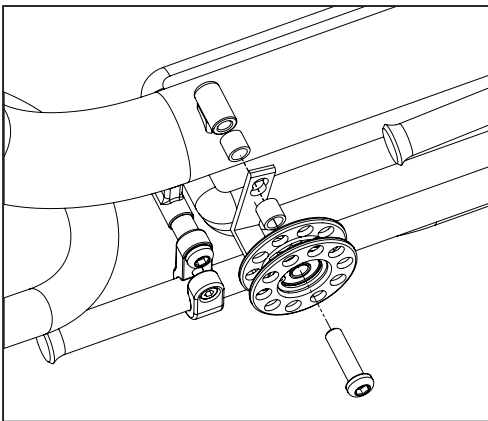

## Upper Chain Tube Setup

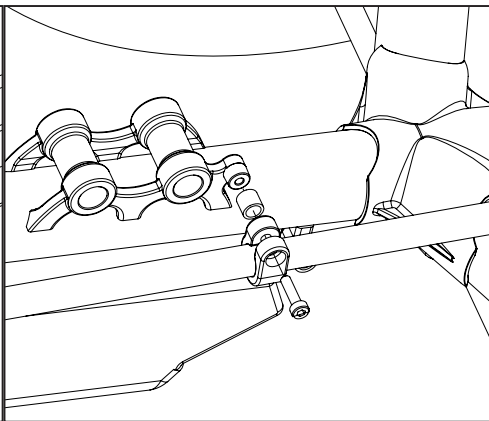

# Parts List

Upper Assy.	Chain Tube, 56 LDPE	TT000548	1
	Chain Tube Clamp, GT	TT000697	1
	Spacer, GT Chain Tube	TT000700	1
	M5x35 SHSCS SS	TT000436	1
Lower Assy.	Chain Tube, 56 LDPE	TT000548	1
	Chain Tube, Clamp, Traveler	TT000422	2
	Idler Wheel Spacer	TT000262	2
	M8x30mm BHCS SS	TT000280	2
	M5x18mm PHSS	N/A	2
Idler Assy.	Idler, 10t Deluxe	TT000261	1
	Idler “L” Bracket	TT000263	1
	Idler Wheel Spacer	TT000262	2
	M8x35mm BHSCS SS	TT000279	1

## Chain Routing

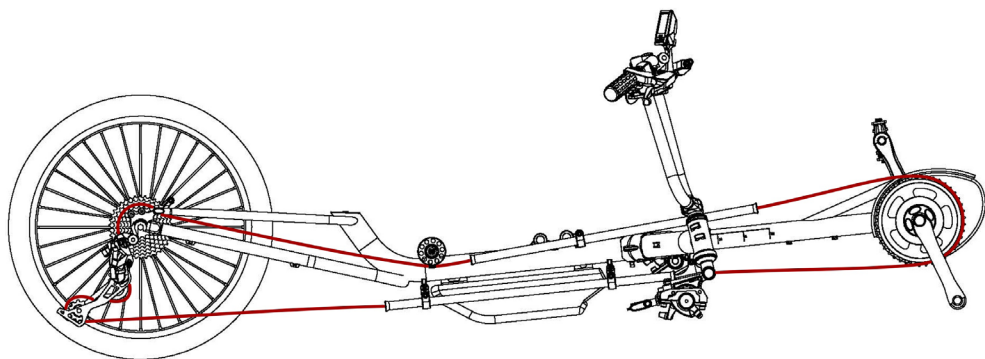

## Cable Routing RH

Brake Cable

Shift Cable

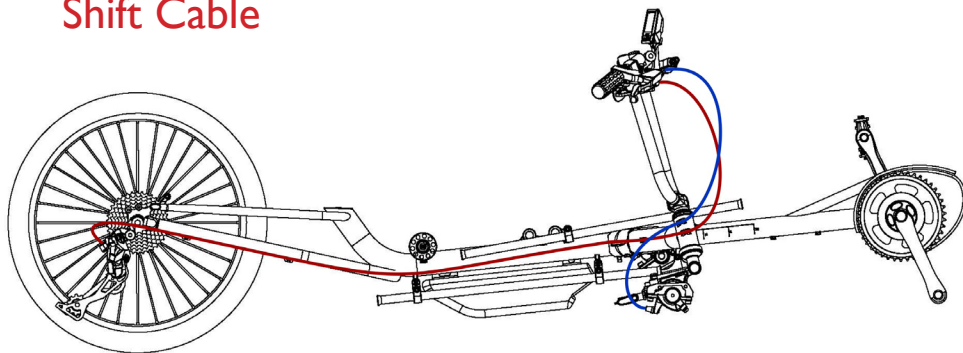

## Cable Routing LH

Brake Cable

Display Cable

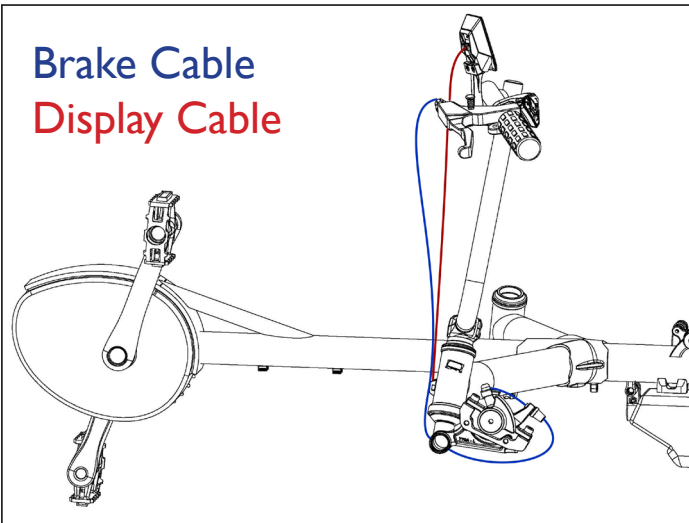

-Charge the battery pack completely.

Instructions for charging are located on

TerraTrike's website at:

<https://www.terratrike.com/resources/manuals/>

Scroll down to locate the battery manual.

-Complete the trike assembly.

-Secure the battery with the additional safety strap.

-Remember to double check your work.

-Test ride the finished product.

-Final step: Watch your customers smile with excitement as they test the intuitive power of the Bosch E.V.O.





# ***TerraTrike®***

800.945.9910 | [www.TerraTrike.com](http://www.TerraTrike.com)  
4460 40th St. SE | Grand Rapids, MI 49512 USA



Revised 6/2022