

Spyder Boost Kit with Bosch Active Line Plus Dealer Assembly Manual

Serial Number: _____

Ensure Boost Kit serial number (located on the inside of the boom tube) matches the order and the specifications of the trike it is to be mounted on.



Warning: Failure to match Boost Kit and the trike specifications it is programmed for could result in an error code, will cause the Boost Kit to not operate properly, and will void the warranty for the Boost Kit.

PLEASE NOTE

Perform the following before installing the Bosch Boost Kit:

- Remove pedals from stock boom (if equipped).**
- Detach shift cable from front derailleur.**
- Remove left hand shift assembly (shifters, cables, housing).**
- Install left handlebar end cap.**
- Break chain.**
- Remove stock boom.**

Boost Kit Components:

Speed Sensor
Magnet



Battery Lock
Key

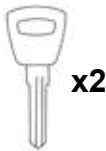

Battery
Clamps



M5x12mm



Bar End Cap



Spacer



M5x55mm

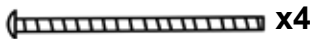

Accessory Top Cap Mount



Computer Sensor Bracket

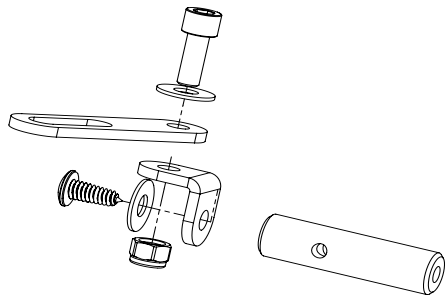

Anti Rotation Bracket

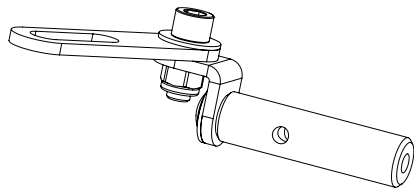
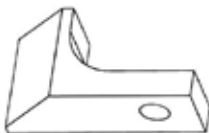

1

Using caution to not stress wires, insert boom to desired length and tighten boom pinch bolts to 13Nm.

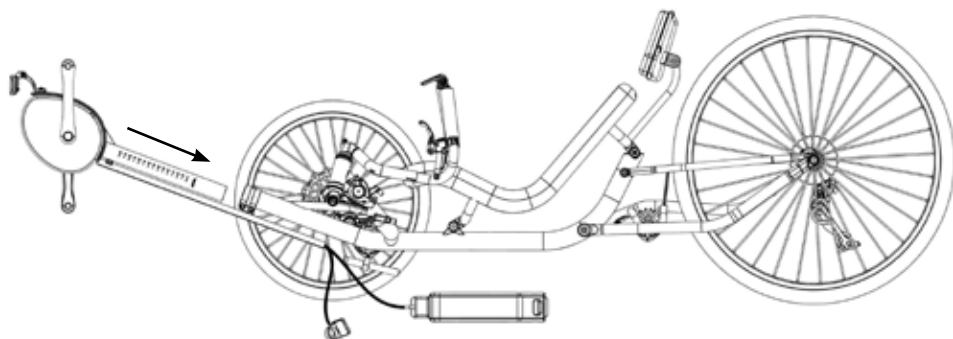

2

Attach spacers to battery plate using the M5x12 bolts.

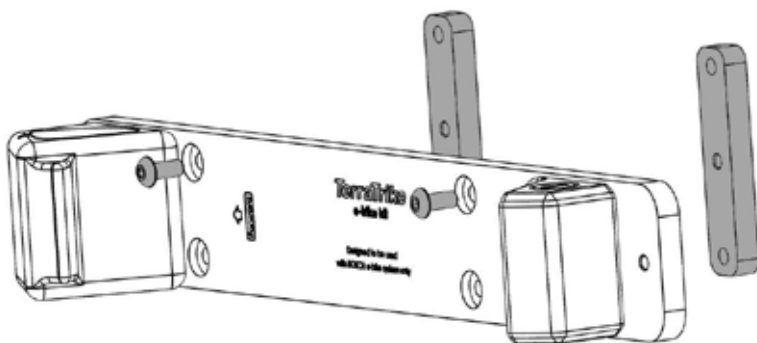

3

Using the M5x55 bolts and clamps, mount the battery plate to the side of the frame. Ensure the clamps are placed on either side of the seat rail – leave bolts loose. Slide battery plate assembly back toward seat mount until lock tab is fully engaged into seat mount. Torque clamp bolts to 4-4.5Nm.

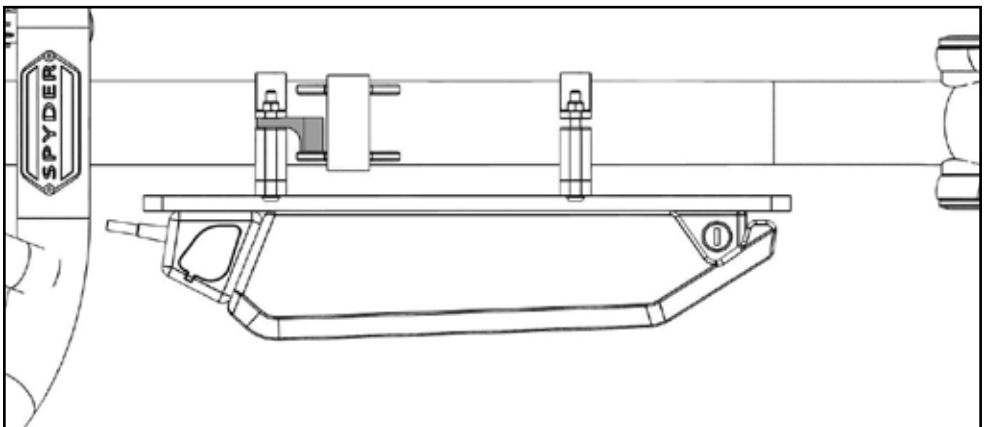
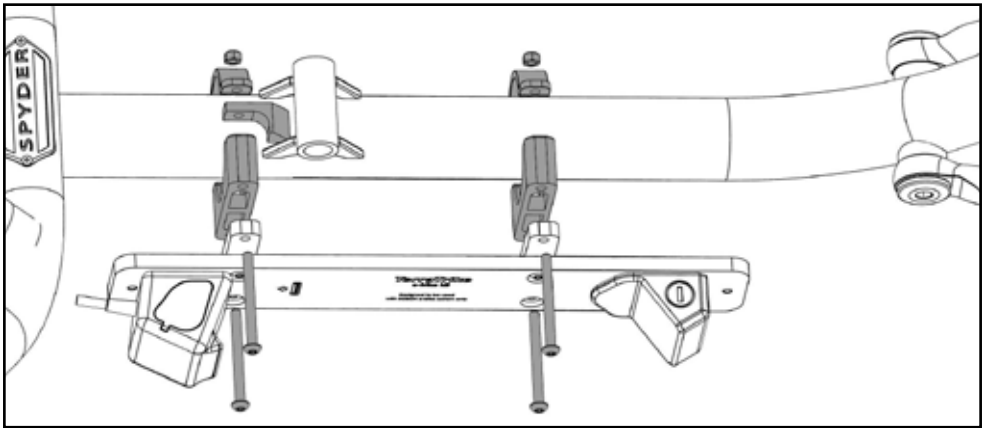

4

Reinstall chain and pedals.

5

Remove LH top cap and bolt.
Install accessory top cap mount for display.
Attach Purion display to mount and secure.

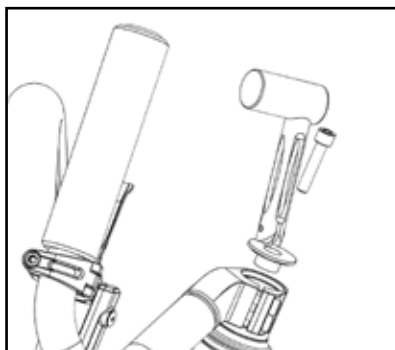

Speed Sensor cable
Purion display cable

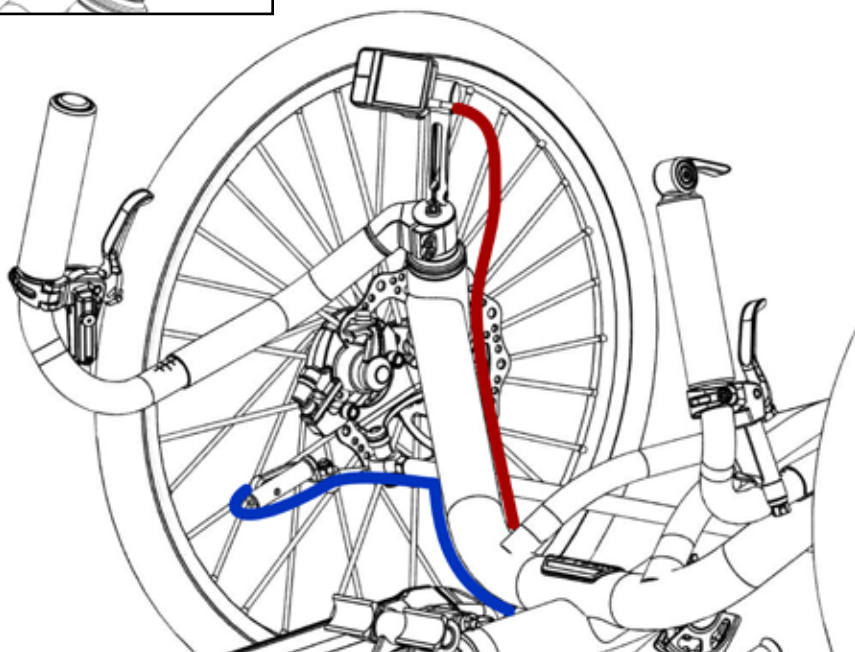

6

Route wires according to diagram. Secure cables with zip ties - do not overtighten.

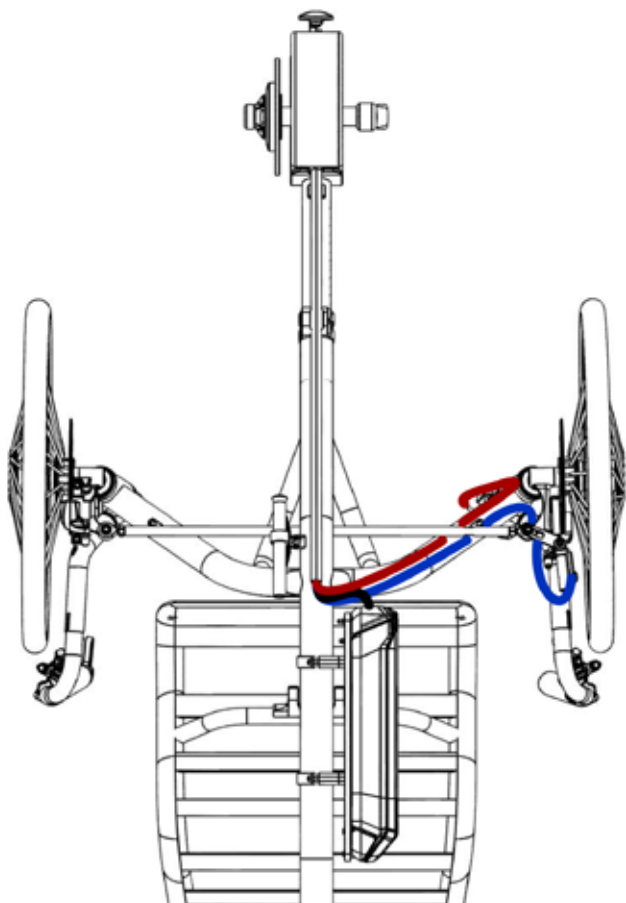

7

Install speed sensor bracket above the tie rod and hubmount.

Mount speed sensor on computer sensor bracket.

Install magnet on spoke.

Align magnet with marking on speed sensor.

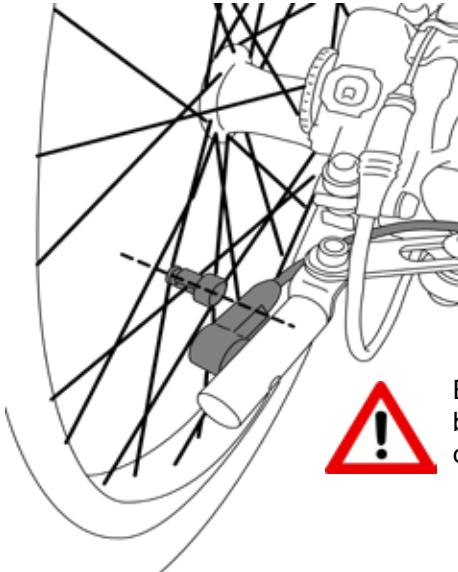
**8**

Affix Class 1 Sticker to mainframe behind fixed seat rail.

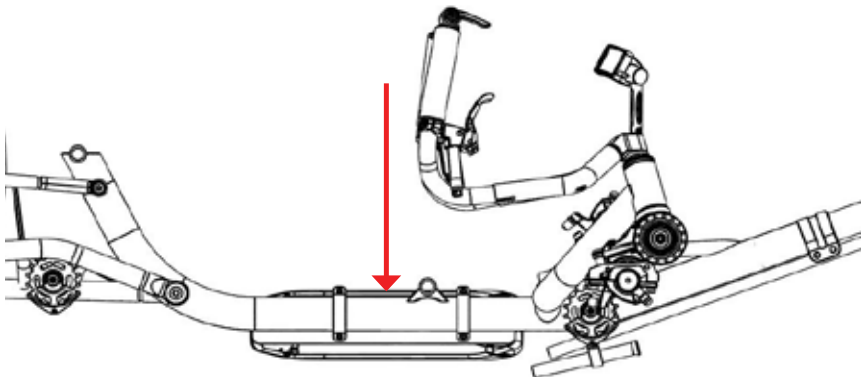

Charge the battery pack completely.

Secure battery to frame using included battery strap.

Visit www.terratrike.com/resources/manuals for manuals, build notes and more.

-Remember to double check your work.

-Test ride the finished product.

-Final step: Watch your customers smile with excitement as they test the intuitive power of the Boost Kit with Bosch Active Line Plus motor.

Item	Part No.
Bosch Boom, Spyder	TT001051
Battery 400wh	TT000748
Battery Cable	TT000749
Battery Mounting Kit	TT000750
Battery Top Bracket	WC000070
Cable Management Tube	WC000079
Charger (2A)	TT000751
Charger Power Cord	TT000752
Purion Display	TT000753
Active Line Plus Drive Unit	TT000754
Abus Lock Cylinder	TT000766
Speed Sensor Magnet	TT000755
P65 Motor Cover	TT000847
Motor Mounting Kit	TT000757
Speed Sensor Cable	TT000758
Cable Guide	WH000075
Bosch Crankset	TT000767
Accessory Mount, Top Cap	WC000116
Battery 440wh EU/AU	WC000044
Charger Power Cable AU	WC000045
Drive unit ALP EU/AU	WC000046

TerraTrike®

TerraTrike®

800.945.9910 | www.TerraTrike.com
4460 40th St. SE | Grand Rapids, MI 49512 USA

